

Site Inventory Form
State Historical Society of Iowa
 (November 2005)

State Inventory No. 09-00788

New Supplemental

Part of a district with known boundaries (enter inventory no.) 09-00621

Relationship: Contributing Noncontributing

Contributes to a potential district with yet unknown boundaries

National Register Status:(any that apply) Listed De-listed NHL DOE

9-Digit SHPO Review & Compliance (R&C) Number _____

Non-Extant (enter year) _____

1. Name of Property

historic name Hay, Henry and Marie, House

other names/site number _____

2. Location

street & number 609 5th Ave NW

city or town Waverly

vicinity, county Bremer

Legal Description: (If Rural) Township Name _____

Township No. _____

Range No. _____

Section _____

Quarter _____

of Quarter _____

(If Urban) Subdivision Knott Addition

Block(s) 57

Lot(s) 2

3. State/Federal Agency Certification [Skip this Section]

4. National Park Service Certification [Skip this Section]

5. Classification

Category of Property (Check only one box)

- building(s)
- district
- site
- structure
- object

Number of Resources within Property

If Non-Eligible Property

Enter number of:

— buildings
 — sites
 — structures
 — objects
 — Total

If Eligible Property, enter number of:

Contributing Noncontributing

2 — buildings
 — — sites
 — — structures
 — — objects
2 — Total

Name of related project report or multiple property study (Enter "N/A" if the property is not part of a multiple property examination).

Title

Historical Architectural Data Base Number

Waverly's NW & SE Neighborhoods Historical & Architectural Survey

09-028

6. Function or Use

Historic Functions (Enter categories from instructions)

Current Functions (Enter categories from instructions)

01A Single Dwelling

01A Single Dwelling

01C05 Garage

01C05 Garage

7. Description

Architectural Classification (Enter categories from instructions)

Materials (Enter categories from instructions)

10B Minimal Traditional

foundation

10A Concrete/Block

walls (visible material) 05E Metal/Aluminium

roof

08A Asphalt/Shingle

other _____

Narrative Description (SEE CONTINUATION SHEETS, WHICH MUST BE COMPLETED)

8. Statement of Significance

Applicable National Register Criteria (Mark "x" representing your opinion of eligibility after applying relevant National Register criteria)

- Yes No More Research Recommended
- Yes No More Research Recommended
- Yes No More Research Recommended
- Yes No More Research Recommended

- A Property is associated with significant events.
- B Property is associated with the lives of significant persons.
- C Property has distinctive architectural characteristics.
- D Property yields significant information in archaeology or history.

County Bremer
City Waverly

Address 609 5th NW

Site Number 09-00788
District Number 09-00621

Criteria Considerations

- A Owned by a religious institution or used for religious purposes.
- B Removed from its original location.
- C A birthplace or grave.
- D A cemetery.
- E A reconstructed building, object, or structure.
- F A commemorative property.
- G Less than 50 years of age or achieved significance within the past 50 years.

Areas of Significance (Enter categories from instructions)

02 ARCHITECTURE

Significant Dates

Construction date
1950 check if circa or estimated date
Other dates, including renovation
1951 - Garage

Significant Person

(Complete if National Register Criterion B is marked above)

Architect/Builder

Architect

Builder

Narrative Statement of Significance (SEE CONTINUATION SHEETS, WHICH MUST BE COMPLETED)

9. Major Bibliographical References

Bibliography See continuation sheet for citations of the books, articles, and other sources used in preparing this form

10. Geographic Data

UTM References (OPTIONAL)

Zone	Easting	Northing	Zone	Easting	Northing
1	_____	_____	2	_____	_____
3	_____	_____	4	_____	_____

See continuation sheet for additional UTM references or comments

11. Form Prepared By

name/title Marlys Svendsen, Svendsen Tyler, Inc. date 9/2013
 organization for City of Waverly, Historic Preservation Commission telephone 715/469-3300
 street & number N3834 Deep Lake Road city or town Sarona state WI zip code 54870

ADDITIONAL DOCUMENTATION (Submit the following items with the completed form)

FOR ALL PROPERTIES

- Map:** showing the property's location in a town/city or township.
- Site plan:** showing position of buildings and structures on the site in relation to public road(s).
- Photographs:** representative black and white photos. If the photos are taken as part of a survey for which the Society is to be curator of the negatives or color slides, a photo/catalog sheet needs to be included with the negatives/slides and the following needs to be provided below on this particular inventory site:

Roll/slide sheet # _____	Frame/slot # _____	Date Taken _____
Roll/slide sheet # _____	Frame/slot # _____	Date Taken _____
Roll/slide sheet # _____	Frame/slot # _____	Date Taken _____

- See continuation sheet or attached *photo & slide catalog sheet* for list of photo roll or slide entries.
- Photos/illustrations without negatives are also in this site inventory file.

FOR CERTAIN KINDS OF PROPERTIES, INCLUDE THE FOLLOWING AS WELL

- Farmstead & District:** (List of structures and buildings, known or estimated year built, and contributing or noncontributing status)
- Barn:**
 - A sketch of the frame/truss configuration in the form of drawing a typical middle bent of the barn.
 - A photograph of the loft showing the frame configuration along one side.
 - A sketch floor plan of the interior space arrangements along with the barn's exterior dimensions in feet.

State Historic Preservation Office (SHPO) Use Only Below This Line

Concur with above survey opinion on National Register eligibility: Yes No More Research Recommended
 This is a locally designated property or part of a locally designated district.

Comments: _____

Evaluated by (name/title): _____ Date: _____

Iowa Site Inventory Form Continuation Sheet

Page 1

Hay, Henry and Marie, House	Bremer
Name of Property	County
609 5 th Ave NW	Waverly
Address	City

7. Description

This single-family house is estimated to have been built in 1948 according to Bremer County Assessor records. The house form and style are consistent with houses in Waverly built after World War II. A house first appears in the 1952 Sanborn Map. The property was owned by Fred Seeman and his wife Mary beginning in 1900 and transferred to Arlo Courbat in October 1939. He transferred the property to Donald Schoof in 1948 who may have undertaken construction of the house. By 1954 the property was held by Henry and Marie Hay and they were residing at this address according to the 1954 telephone directory. Together these public records suggest that the house was erected between ca. 1948 and ca. 1950.

This frame house is an example of a vernacular 1-story Minimal Traditional house form. This variation has a detached garage. The house has a concrete block foundation with wide clapboard-style aluminum siding on the walls. The house has a moderate-pitched side-gable roof with shallow eaves on the slopes and no eaves on the gable ends. A shed-roofed wing and cutaway porch is formed by an extension of the front roof slope.

Fenestration includes single 2/2 double-hung windows of several sizes with horizontal lights. Single windows are symmetrically placed on the gabled ends with a variation of a Chicago window group as the feature window in the projecting front wing. It consists of a large square fixed sash flanked by 2/2. (horizontal lights) double-hung units. The original single-bay garage is southeast of the east gable end wall. According to Assessor records, it was constructed in 1951. It has vertical tongue-and-groove boards for the siding and the original wagon-style garage doors still in place.

Alterations: aluminum siding (undated); garage (1951).

8. Significance

The Hay House at 609 5th Ave NW was built in ca. 1950 is an example of a Minimal Traditional house form from the post World War II period. The house qualifies for the National Register of Historic Places as a contributing resource to the historic district under Criteria A and C.

The property was owned by Fred Seeman and his wife Mary beginning in 1900 and transferred to Arlo Courbat in October 1939. He transferred the property to Donald Schoof in 1948 who may have undertaken construction of the house a short time later. By 1954 the property was owned by Henry and Marie Hay, retired farmers. They were listed in telephone directories at this house beginning in 1954.

9. Sources

Atlas of Bremer County, Iowa. Waverly, Iowa: Waverly Publishing Company, 1917.

Atlases of Bremer County. microfilm copies of atlases for 1875, 1894 and 1927, Waverly Public Library.

Iowa Site Inventory Form Continuation Sheet

Page 2

Hay, Henry and Marie, House	Bremer
Name of Property	County
609 5 th Ave NW	Waverly
Address	City

Bremer County History Book Committee. *Bremer County History, 1985*. Dallas, Texas: Taylor Publishing, 1985.

Grawe, Joseph F. *History of Bremer County, Iowa, Volumes I and II*. Chicago: S.J. Clarke Company, 1914.

History of Butler and Bremer Counties, Iowa. Springfield, Illinois: Union Publishing, 1883.

Sanborn Company Maps. New York: Sanborn Map Company, 1885, 1892, 1897, 1905, 1915, 1927, and 1927 updated to 1943.

Vertical file collection, Waverly Public Library.

Waverly building histories, miscellaneous bound volumes in reference collection, Waverly Public Library.

Waverly city directories, 1899 and 1913.

Waverly Heritage Days historical walking tour brochures for 1995, 1996, 1997, 1998, 1999 and 2000.

Waverly Historic Photo Collection, Waverly Public Library.

Iowa Department of Cultural Affairs
State Historical Society of Iowa
**Iowa Site Inventory Form
Continuation Sheet**

Site Number 09-00788
Related District Number 09-00621

Page 3

Hay, Henry and Marie, House
Name of Property
609 5th Ave NW
Address

Bremer
County
Waverly
City

Site Map: Bremer County GIS Department, 12/2011.

**609 5th Ave NW
PIN 05-34-490-003**



Iowa Department of Cultural Affairs
State Historical Society of Iowa
**Iowa Site Inventory Form
Continuation Sheet**

Site Number 09-00788
Related District Number 09-00621

Page 4

Hay, Henry and Marie, House

Bremer

Name of Property

County

609 5th Ave NW

Waverly

Address

City

Photographs: 609 5th Ave NW, looking southwest and southeast, Marlys Svendsen, photographer, 11/3/2011.



Iowa Department of Cultural Affairs
State Historical Society of Iowa
**Iowa Site Inventory Form
Continuation Sheet**

Site Number 09-00788
Related District Number 09-00621

Page 5

Hay, Henry and Marie, House

Bremer

Name of Property

County

609 5th Ave NW

Waverly

Address

City

Photographs: 609 5th Ave NW, looking southwest towards detached garage as well as window and foundation details, Marlys Svendsen, IHSEMD, photographer, 11/3/2011.



Iowa Department of Cultural Affairs
 State Historical Society of Iowa
Iowa Site Inventory Form
Continuation Sheet

Site Number 09-00788
 Related District Number 09-00621

Page 6

Hay, Henry and Marie, House	Bremer
Name of Property	County
609 5 th Ave NW	Waverly
Address	City

Additional Information:

Floor plan, 609 5th Ave NW, Bremer County Assessor website; available at <http://beacon.schneidercorp.com/PhotoEngine/Sketch.aspx?appid=330&keyvalue=0534490003&index=0&size=0>; accessed 10/22/2012

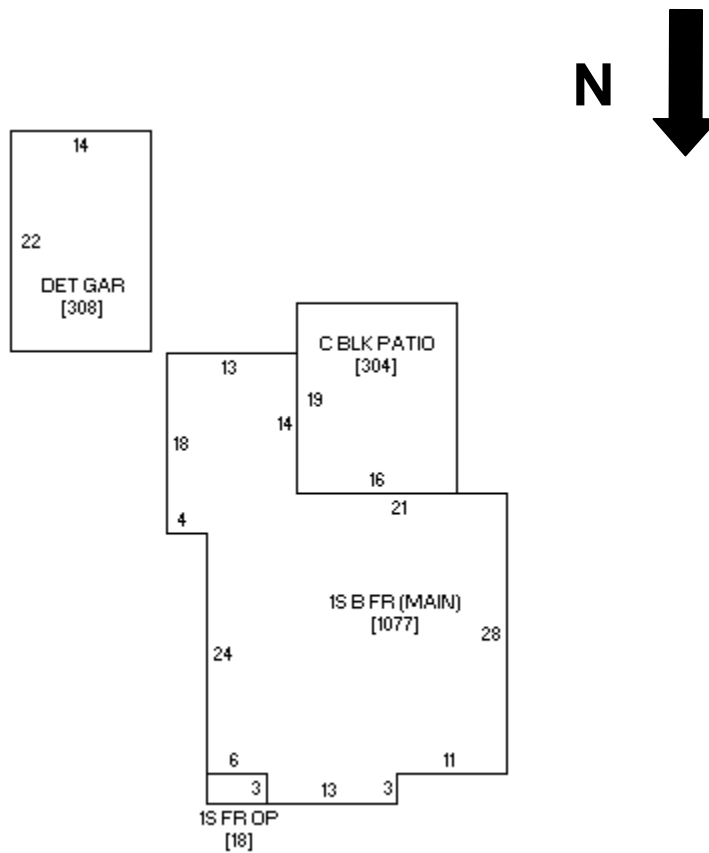

Sketch by www.camavision.com