

Site Inventory Form
State Historical Society of Iowa
 (November 2005)

State Inventory No. 09-00685 New Supplemental
 Part of a district with known boundaries (enter inventory no.) 09-00621
 Relationship: Contributing Noncontributing
 Contributes to a potential district with yet unknown boundaries
 National Register Status:(any that apply) Listed De-listed NHL DOE
 9-Digit SHPO Review & Compliance (R&C) Number _____
 Non-Extant (enter year) _____

1. Name of Property

historic name Gertsch, Albert, House
 other names/site number _____

2. Location

street & number 214 3rd Ave NW
 city or town Waverly vicinity, county Bremer
 Legal Description: (If Rural) Township Name _____ Township No. _____ Range No. _____ Section _____ Quarter of Quarter _____
 (If Urban) Subdivision Harmon & LeValley Add. Block(s) 33 Lot(s) E 54' Lot 6

3. State/Federal Agency Certification [Skip this Section]

4. National Park Service Certification [Skip this Section]

5. Classification

Category of Property (Check only one box)	Number of Resources within Property	
	If Non-Eligible Property Enter number of:	If Eligible Property, enter number of: Contributing Noncontributing
<input checked="" type="checkbox"/> building(s)	_____ buildings	<u>1</u> buildings
<input type="checkbox"/> district	_____ sites	_____ sites
<input type="checkbox"/> site	_____ structures	_____ structures
<input type="checkbox"/> structure	_____ objects	_____ objects
<input type="checkbox"/> object	_____ Total	<u>1</u> Total

Name of related project report or multiple property study (Enter "N/A" if the property is not part of a multiple property examination).
 Title Waverly's NW & SE Neighborhoods Historical & Architectural Survey Historical Architectural Data Base Number 09-028

6. Function or Use

Historic Functions (Enter categories from instructions)	Current Functions (Enter categories from instructions)
<u>01A Single Dwelling</u>	<u>01A03 Single Dwelling w/ attached garage</u>
_____	_____
_____	_____

7. Description

Architectural Classification (Enter categories from instructions)	Materials (Enter categories from instructions)
<u>09A06 Hipped Roof, 2-story</u>	foundation <u>10A Concrete Block</u>
_____	walls (visible material) <u>15B Vinyl</u>
_____	roof <u>08A Asphalt/Shingle</u>
_____	other _____

Narrative Description (SEE CONTINUATION SHEETS, WHICH MUST BE COMPLETED)

8. Statement of Significance

Applicable National Register Criteria (Mark "x" representing your opinion of eligibility after applying relevant National Register criteria)	
<input checked="" type="checkbox"/> Yes <input type="checkbox"/> No <input type="checkbox"/> More Research Recommended	A Property is associated with significant events.
<input type="checkbox"/> Yes <input checked="" type="checkbox"/> No <input type="checkbox"/> More Research Recommended	B Property is associated with the lives of significant persons.
<input checked="" type="checkbox"/> Yes <input type="checkbox"/> No <input type="checkbox"/> More Research Recommended	C Property has distinctive architectural characteristics.
<input type="checkbox"/> Yes <input checked="" type="checkbox"/> No <input type="checkbox"/> More Research Recommended	D Property yields significant information in archaeology or history.

County Bremer
City Waverly

Address 214 3rd Ave NW

Site Number 09-00685
District Number 09-00621

Criteria Considerations

- A Owned by a religious institution or used for religious purposes.
- B Removed from its original location.
- C A birthplace or grave.
- D A cemetery.
- E A reconstructed building, object, or structure.
- F A commemorative property.
- G Less than 50 years of age or achieved significance within the past 50 years.

Areas of Significance (Enter categories from instructions)

02 ARCHITECTURE

Significant Dates

Construction date
1903 check if circa or estimated date
Other dates, including renovation

Significant Person

(Complete if National Register Criterion B is marked above)

Architect/Builder

Architect

Builder

Narrative Statement of Significance (SEE CONTINUATION SHEETS, WHICH MUST BE COMPLETED)

9. Major Bibliographical References

Bibliography See continuation sheet for citations of the books, articles, and other sources used in preparing this form

10. Geographic Data

UTM References (OPTIONAL)

Zone	Easting	Northing	Zone	Easting	Northing
1	_____	_____	2	_____	_____
3	_____	_____	4	_____	_____

See continuation sheet for additional UTM references or comments

11. Form Prepared By

name/title Marlys Svendsen, Svendsen Tyler, Inc.
organization for City of Waverly, Historic Preservation Commission
street & number N3834 Deep Lake Road
city or town Sarona state WI date 9/2013
telephone 715/469-3300
zip code 54870

ADDITIONAL DOCUMENTATION (Submit the following items with the completed form)

FOR ALL PROPERTIES

- Map:** showing the property's location in a town/city or township.
- Site plan:** showing position of buildings and structures on the site in relation to public road(s).
- Photographs:** representative black and white photos. If the photos are taken as part of a survey for which the Society is to be curator of the negatives or color slides, a photo/catalog sheet needs to be included with the negatives/slides and the following needs to be provided below on this particular inventory site:

Roll/slide sheet # _____	Frame/slot # _____	Date Taken _____
Roll/slide sheet # _____	Frame/slot # _____	Date Taken _____
Roll/slide sheet # _____	Frame/slot # _____	Date Taken _____

See continuation sheet or attached *photo & slide catalog sheet* for list of photo roll or slide entries.

Photos/illustrations without negatives are also in this site inventory file.

FOR CERTAIN KINDS OF PROPERTIES, INCLUDE THE FOLLOWING AS WELL

- Farmstead & District:** (List of structures and buildings, known or estimated year built, and contributing or noncontributing status)
- Barn:**
 - A sketch of the frame/truss configuration in the form of drawing a typical middle bent of the barn.
 - A photograph of the loft showing the frame configuration along one side.
 - A sketch floor plan of the interior space arrangements along with the barn's exterior dimensions in feet.

State Historic Preservation Office (SHPO) Use Only Below This Line

Concur with above survey opinion on National Register eligibility: Yes No More Research Recommended
 This is a locally designated property or part of a locally designated district.

Comments: _____

Evaluated by (name/title): _____ Date: _____

Iowa Site Inventory Form Continuation Sheet

Page 1

Gertsch, Albert, House	Bremer
Name of Property	County
214 3 rd Ave NW	Waverly
Address	City

7. Description

This single-family house is estimated to have been built in 1905 according to Bremer County Assessor records. The house form and style are consistent with similar houses in Waverly built using this form from ca. 1900 to 1925. Property Transfer Records show this property held by A.J. Nile and transferred to Albert Gertsch in April 1901. Construction began in September 1903 according to newspaper listings. A construction completion date of 1905 or shortly earlier is consistent with public records.

This house is an example of a vernacular Hipped Roof, 2-story house form. The house has a rock-faced concrete block foundation on the main block and the walls are clad in narrow-width synthetic clapboard-style siding in the dormers and asbestos shingle siding on the walls. The house has a steeply pitched hipped roof with moderate eaves and gabled attic dormers on the slopes. A broad, low-pitched gable roofed porch spans the front façade. Now enclosed with an asbestos siding for the closed balustrade, louvered windows fill the upper walls with the door centered beneath the gable peak. A second enclosed entrance porch is on the west façade of the main house to provide a separate entrance for the second of three apartment units in the house. Fenestration for the house includes a mix of single and paired 1/1 double-hung windows of various sizes. The front dormer retains its original square window with a perimeter of square lights. The side dormers have single light square sashes.

The house has a 1-story double-bay, attached frame garage along the north façade. The garage was built in 1905 according to the Assessor records but was built sometime after 1927. The house had a detached single car garage in the 1927 Sanborn Map and no side porch.

Alterations: synthetic siding in gables, undated; porch enclosure, undated; side porch construction, undated (post 1927) and garage addition, undated.

8. Significance

The Albert Gertsch House at 214 3rd Ave NW was built in 1905 and is an example of a vernacular Hipped Roof, 2-story house form. The house qualifies for the National Register of Historic Places as a contributing resource to the historic district under Criteria A and C.

Albert Gertsch acquired this property on April 24, 1901 from A.J. Nile and began construction in September 1903 according to news accounts published on September 17 and 24, 1913. No information has been found about Gertsch or his family. For at least a short time, the house was used as a rental house with the occupants in the 1913 city directory being W.A. Remington, a grocer, and his wife Sophia. On February 13, 1913, Gertsch sold the house to Louise Kehe, widow of Henry W. Kehe. It appears that Louise had at least three children including Louise, Margaret and LuVern Kehe. In 1949 Louise transferred the house to Margaret Kehe and twenty years later it passed to LuVern W. Kehe.

9. Sources

Atlas of Bremer County, Iowa. Waverly, Iowa: Waverly Publishing Company, 1917.

Iowa Department of Cultural Affairs
State Historical Society of Iowa
**Iowa Site Inventory Form
Continuation Sheet**

Site Number **09-00685**
Related District Number 09-00621

Page 2

Gertsch, Albert, House	Bremer
Name of Property	County
214 3 rd Ave NW	Waverly
Address	City

Atlases of Bremer County. Microfilm copies of atlases for 1875, 1894 and 1927, Waverly Public Library.

Bremer County History Book Committee. *Bremer County History, 1985.* Dallas, Texas: Taylor Publishing, 1985.

Grawe, Joseph F. *History of Bremer County, Iowa, Volumes I and II.* Chicago: S.J. Clarke Company, 1914.

History of Butler and Bremer Counties, Iowa. Springfield, Illinois: Union Publishing, 1883.

Sanborn Company Maps. New York: Sanborn Map Company, 1885, 1892, 1897, 1905, 1915, 1927, and 1927 updated to 1943.

Warren Township, Iowa Census records, 1885 and 1895.

Waverly building histories, miscellaneous bound volumes in reference collection, Waverly Public Library.

Waverly city directories, 1899 and 1913.

Waverly Heritage Days historical walking tour brochures for 1995, 1996, 1997, 1998, 1999 and 2000.

Waverly Historic Photo Collection, Waverly Public Library.

Waverly Newspapers, September 17 and 24, 1913.

Iowa Department of Cultural Affairs
State Historical Society of Iowa
**Iowa Site Inventory Form
Continuation Sheet**

Site Number **09-00685**
Related District Number **09-00621**

Page 3

Name of Property Gertsch, Albert, House	County Bremer
Address 214 3 rd Ave NW	City Waverly

Site Map: Bremer County GIS Department, 12/2011.

**214 3rd Ave NW
PIN 09-02-106-007**

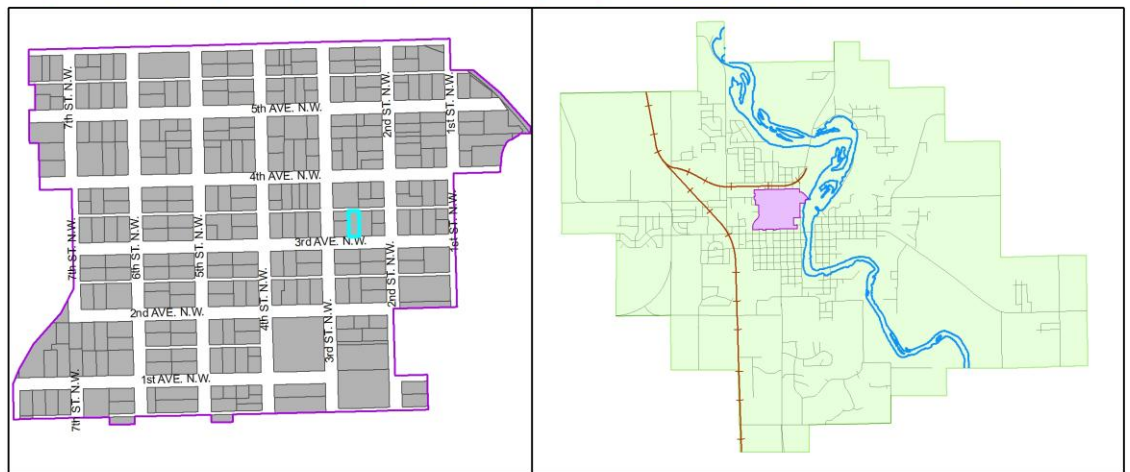

Iowa Department of Cultural Affairs
State Historical Society of Iowa
**Iowa Site Inventory Form
Continuation Sheet**

Site Number **09-00685**
Related District Number 09-00621

Page 4

Gertsch, Albert, House	Bremer
Name of Property	County
214 3 rd Ave NW	Waverly
Address	City

Photographs: 214 3rd Ave NW, looking northwest and northeast, Marlys Svendsen, photographer, 11/16/2011.



Iowa Department of Cultural Affairs
State Historical Society of Iowa
Iowa Site Inventory Form
Continuation Sheet

Site Number **09-00685**
Related District Number 09-00621

Page 5

Gertsch, Albert, House

Bremer

Name of Property

County

214 3rd Ave NW

Waverly

Address

City

Photographs: 214 3rd Ave NW, looking northwest and north, Justine Zimmer, IHSEMD, photographer, 1/16/2011.



Iowa Department of Cultural Affairs
 State Historical Society of Iowa
Iowa Site Inventory Form
Continuation Sheet

Site Number **09-00685**
 Related District Number 09-00621

Page 6

Gertsch, Albert, House	Bremer
Name of Property	County
214 3 rd Ave NW	Waverly
Address	City

Floor Plan: Bremer County Assessor's website; available at: <http://beacon.schneidercorp.com/PhotoEngine/Sketch.aspx?appid=330&keyvalue=0902106007&index=0&size=0>; accessed 12/26/2012.

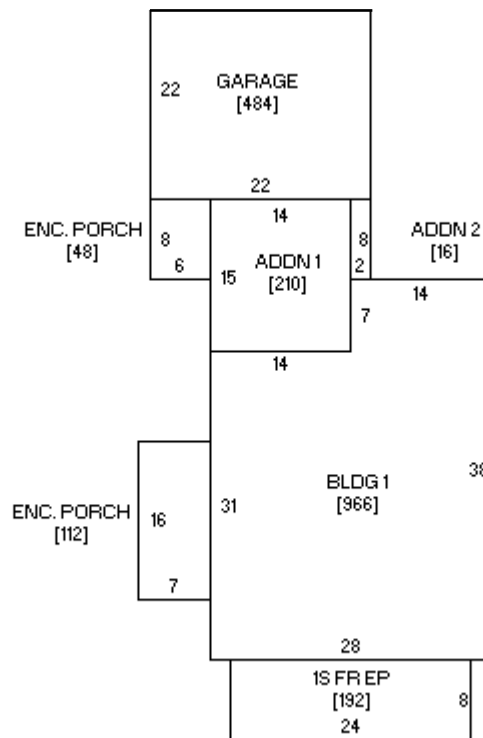

Sketch by www.camavision.com